

Locus Plans
Exhibits 1 and 2

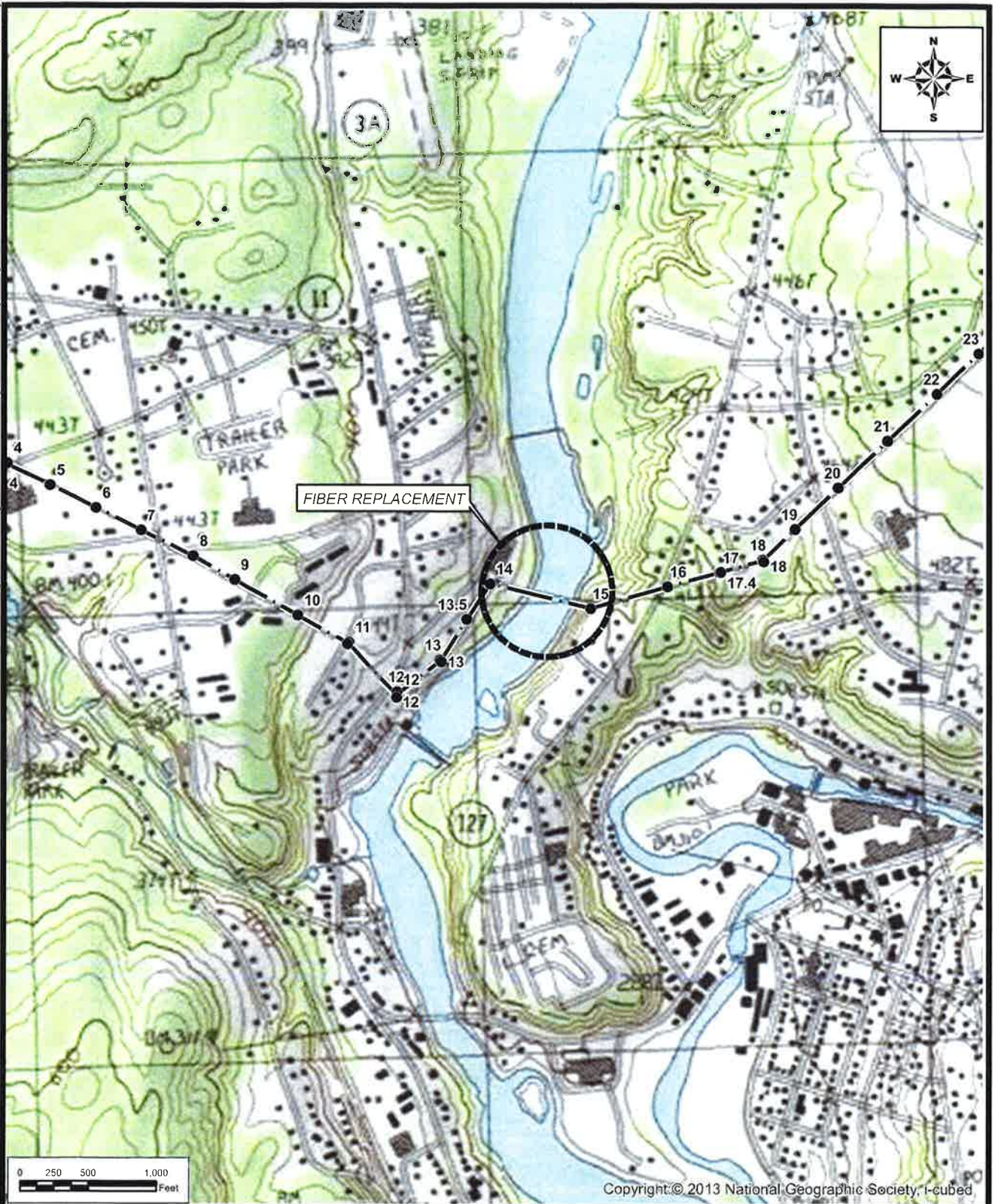

UNLESS SPECIFICALLY STATED BY WRITTEN AGREEMENT, THIS DRAWING IS THE SOLE PROPERTY OF GZA GEOENVIRONMENTAL, INC. (GZA). THE INFORMATION SHOWN ON THE DRAWING IS SOLELY FOR THE USE BY GZA'S CLIENT OR THE CLIENT'S DESIGNATED REPRESENTATIVE FOR THE SPECIFIC PROJECT AND LOCATION IDENTIFIED ON THE DRAWING. THE DRAWING SHALL NOT BE TRANSFERRED, REUSED, COPIED, OR ALTERED IN ANY MANNER FOR USE AT ANY OTHER LOCATION OR FOR ANY OTHER PURPOSE WITHOUT THE PRIOR WRITTEN CONSENT OF GZA. ANY TRANSFER, REUSE, OR MODIFICATION TO THE DRAWING BY THE CLIENT OR OTHERS, WITHOUT THE PRIOR WRITTEN EXPRESS CONSENT OF GZA, WILL BE AT THE USER'S SOLE RISK AND WITHOUT ANY RISK OR LIABILITY TO GZA.

L176 TRANSMISSION LINE FIBER REPLACEMENT PROJECT
FRANKLIN, TILTON, BELMONT, & LACONIA,
NEW HAMPSHIRE

PUBLIC UTILITIES COMMISSION
PEMIGEWASSET RIVER CROSSING UPDATE
ORDER NO. 11,915, DOCKET DE 75-148

NO.		ISSUE / DESCRIPTION		BY	DATE
PREPARED BY:		GZA GeoEnvironmental, Inc. Engineers and Scientists www.gza.com		PREPARED FOR: EVERSOURCE ENERGY	
PROJ MGR:	TLT	REVIEWED BY:	TLT	CHECKED BY:	DMZ
DESIGNED BY:	LEW	DRAWN BY:	LEW	SCALE:	1 in = 1,000 ft
DATE:	SEPTEMBER 2019	PROJECT NO.	04.0190923.11	REVISION NO.	
					FIGURE 1

© 2019 - GZA GeoEnvironmental, Inc. \\CZABedford\Jobs\04\Jobs\01909023\04\0190923.00 - Eversource MSA\04\0190923.11 - L176 Fiber - Welland Permitting\L176 Fiber Figs 2\MXD\DWG Drawings\Water Crossing Winnisquam Lake.mxd, 9/24/2019, 10:56:32 AM, Lindsey White

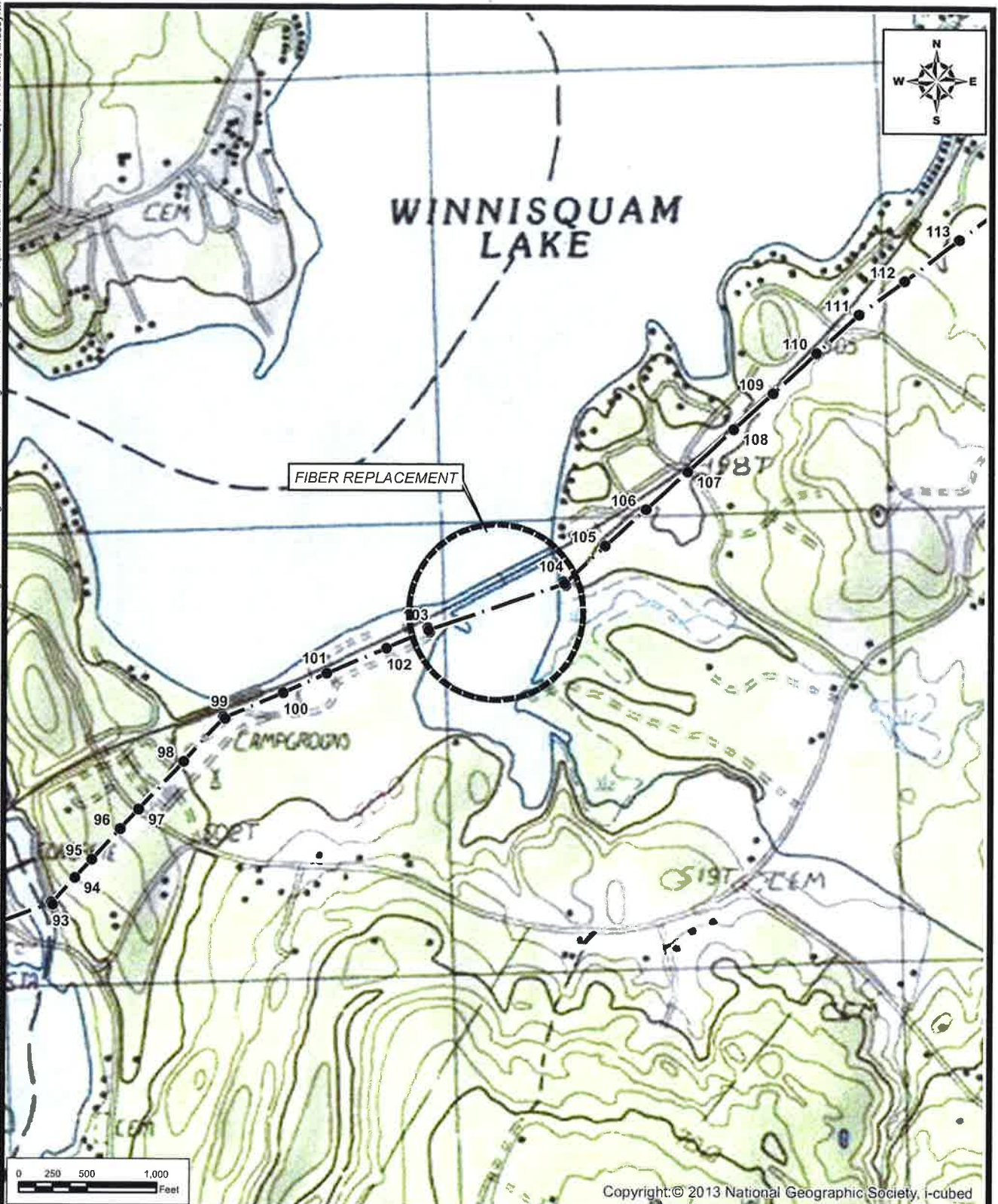

Copyright: © 2013 National Geographic Society, i-cubed

UNLESS SPECIFICALLY STATED BY WRITTEN AGREEMENT, THIS DRAWING IS THE SOLE PROPERTY OF GZA GEOENVIRONMENTAL, INC. (GZA). THE INFORMATION SHOWN ON THE DRAWING IS SOLELY FOR THE USE BY GZA'S CLIENT OR THE CLIENT'S DESIGNATED REPRESENTATIVE FOR THE SPECIFIC PROJECT AND LOCATION IDENTIFIED ON THE DRAWING. THE DRAWING SHALL NOT BE TRANSFERRED, REUSED, COPIED, OR ALTERED IN ANY MANNER FOR USE AT ANY OTHER LOCATION OR FOR ANY OTHER PURPOSE WITHOUT THE PRIOR WRITTEN CONSENT OF GZA. ANY TRANSFER, REUSE, OR MODIFICATION TO THE DRAWING BY THE CLIENT OR OTHERS WITHOUT THE PRIOR WRITTEN EXPRESS CONSENT OF GZA WILL BE AT THE USER'S SOLE RISK AND WITHOUT ANY RISK OR LIABILITY TO GZA.

L176 TRANSMISSION LINE FIBER REPLACEMENT PROJECT
FRANKLIN, TILTON, BELMONT, & LACONIA,
NEW HAMPSHIRE

PUBLIC UTILITIES COMMISSION
WINNISQUAM LAKE CROSSING UPDATE
ORDER NO. 11,949, DOCKET DE 75-149

NO.		ISSUE / DESCRIPTION		BY	DATE
PREPARED BY:		PREPARED FOR:			
GZA GeoEnvironmental, Inc. Engineers and Scientists www.gza.com		EVERSOURCE ENERGY			
PROJ MGR:	TLT	REVIEWED BY:	TLT	CHECKED BY:	DMZ
DESIGNED BY:	LEW	DRAWN BY:	LEW	SCALE:	1 in = 1,000 ft
DATE:		PROJECT NO.		REVISION NO.	
SEPTEMBER 2019		04.0190923.11			

FIGURE
2

Engineer Details

Exhibits 3 and 4

ES VER: 12/2016

9/10/2019 1:17 PM - Slessard - C:\pwworkingemp\pw1\d2903895\L176-PERMIT CROSSING DWGS.dwg - L17643902

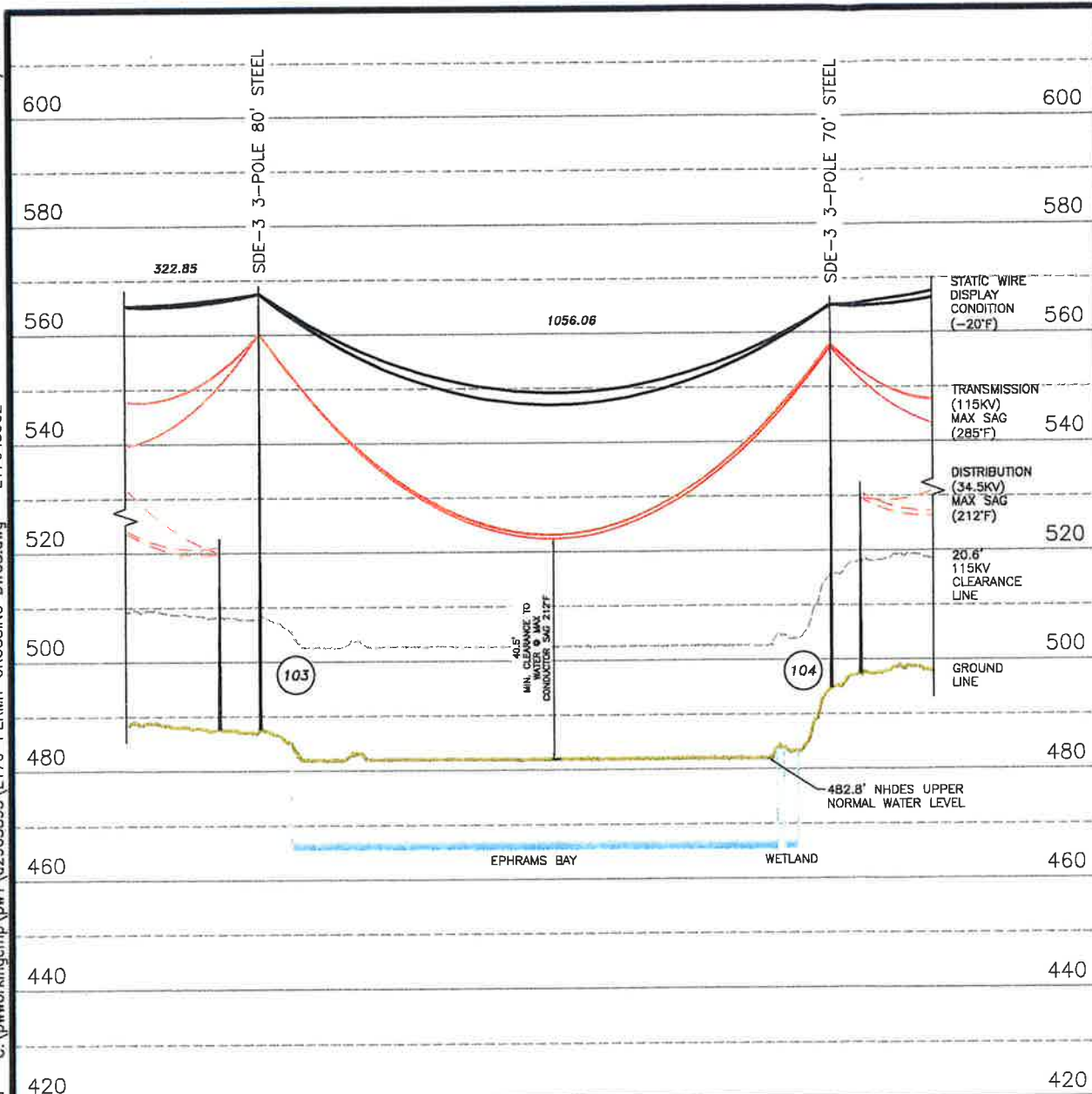

STRUCTURE LOCATION:

STR. #103 - LAT.= 43°28'40.581"N
LONG.= 71°31'19.878"W
STR. #104 - LAT.= 43°28'43.956"N
LONG.= 71°31'6.325"W

CABLE SCHEDULE:

WIRE	# OF CABLES	TYPE	DIA. (IN.)	WEIGHT/ 1000 FT	CABLE STRENGTH (LBS.)
OPGW	1	0.646" OPGW (48F)	0.646	490.0	24,958
STATIC	1	7#8 ALUMOWELD	0.385	261.8	15,930
TRANSMISSION COND.	3	795 KCM 26/7 ACSR	1.108	1093.4	31,500
DISTRIBUTION COND.	3	477 KCM 26/7 ACSR	0.858	655.3	19,500

PROFILE LEGEND:

—	STATIC WIRE	---	DISTRIBUTION WIRE
---	TRANSMISSION WIRE	---	115KV CLEARANCE LINE
---		---	GROUND LINE PROFILE

TOWN OF BELMONT

STR. #103

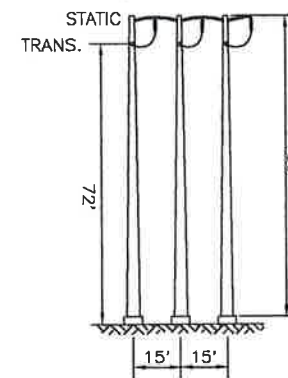

STR. #104

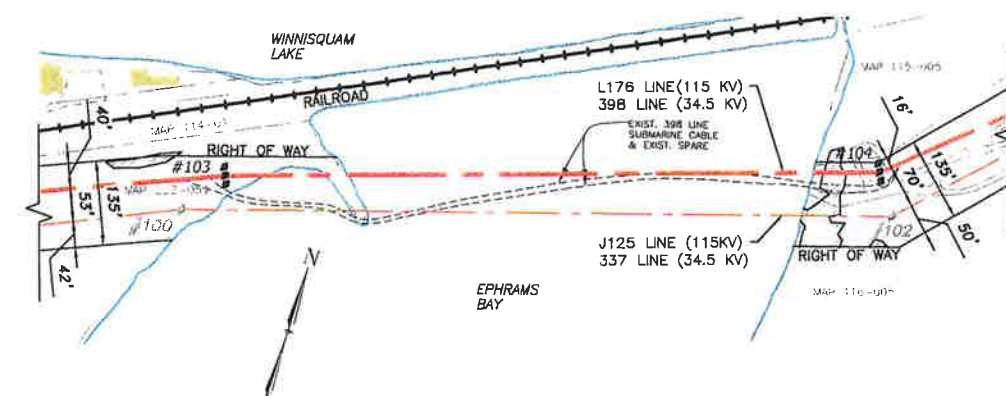
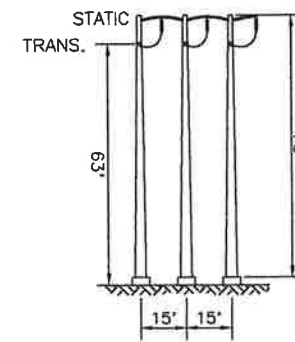

NOTES:

1. VERTICAL DATUM IS NAVD88 IN FEET.
2. COORDINATE SYSTEM IS NEW HAMPSHIRE STATE PLANE NAD 83 US SURVEY FEET.
3. MAP NUMBERS REFER TO TOWN OF BELMONT TAX IDENTIFICATION MAP NUMBERS WITH CORRESPONDING PARCEL IDENTIFICATION NUMBERS.



DWG	REV	DESCRIPTION	DATE	DRN	CHKD	APPR
1		ISSUED FOR PERMIT	9/10/19	DRL	SAL	GEL
0.1		RE-ISSUED FOR PERMIT	12/27/17	JLD	BAF	CRP
0		ISSUED FOR PERMIT	9/29/17	RDW	BAF	GEL

EVERSOURCE
ENERGY

LINE L176 115KV TRANSMISSION
NHPUC WATER CROSSING PETITION
WINNISQUAM LAKE
EXHIBIT 3

SCALE: NTS
FILE: L176-PERMIT CROSSING DWGS.DWG
IMAGE:

T	1
DRAWN	JJD/TRC
ENGINEER	CRP/TRC
CHECKED	BAF/TRC
APPROVED	GEL/TRC
DATE	6/8/17
DRAWING NO.	L17643902

ES VER: 12/2016

C:\pwworkingmp\pw1\d2903895\L176-PERMIT CROSSING DWGS.dwg - L17643903

9/10/2019 1:17 PM - Slessard -

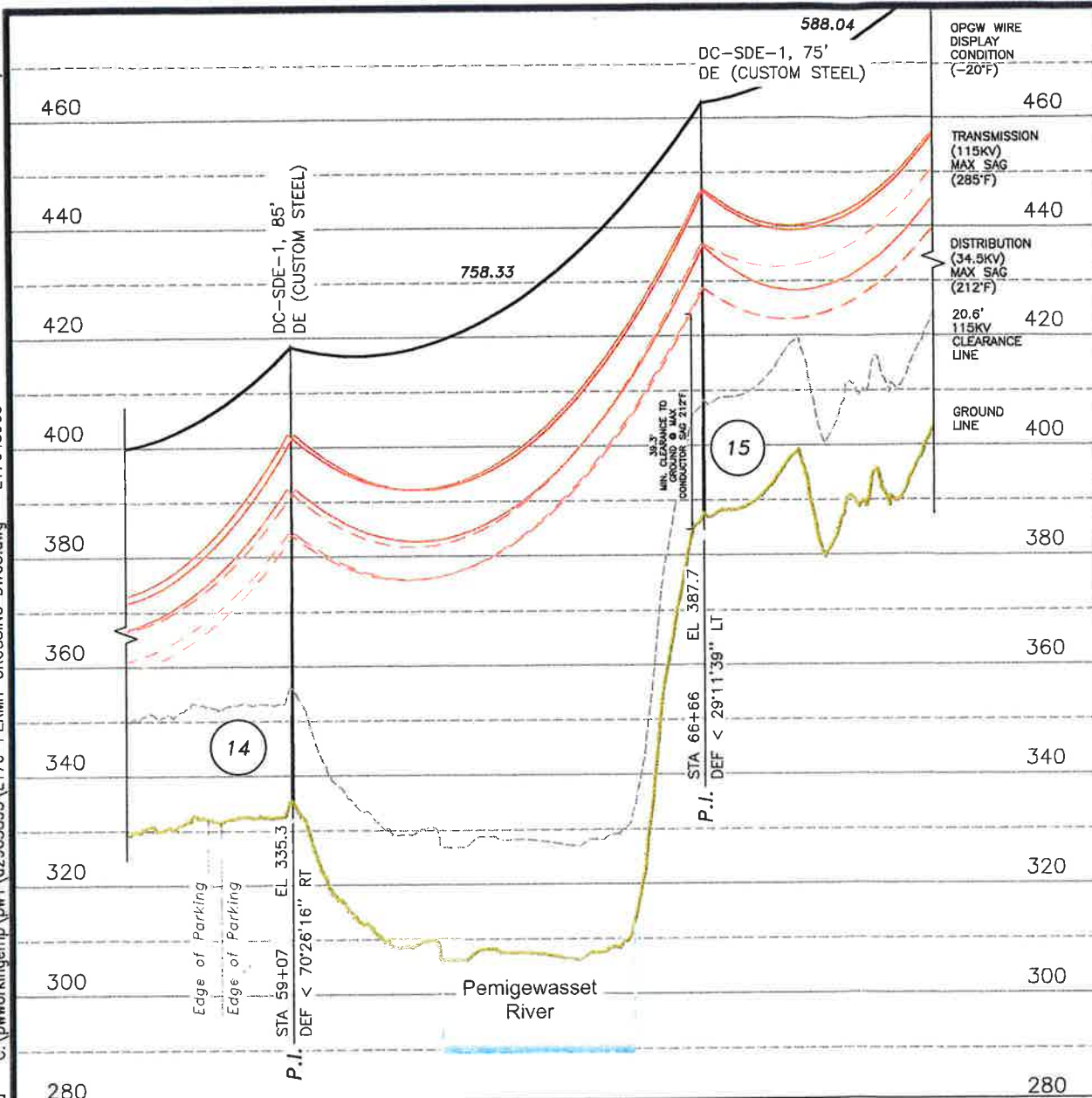

STRUCTURE LOCATION:

STR. #14 - LAT.= 43°27'1.628"N
LONG.= 71°39'21.982"W
STR. #15 - LAT.= 43°26'59.854"N
LONG.= 71°39'11.964"W

CABLE SCHEDULE:

WIRE	# OF CABLES	TYPE	DIA. (IN.)	WEIGHT/1000 FT	CABLE STRENGTH (LBS.)
OPGW	1	0.646" OPGW (48F)	0.646	490.0	24,958
TRANSMISSION COND.	3	795 KCM 26/7 ACSR	1.108	1093.4	31,500
DISTRIBUTION COND.	3	477 KCM 26/7 ACSR	0.858	655.3	19,500

PROFILE LEGEND:

—	STATIC WIRE	---	DISTRIBUTION WIRE
---	TRANSMISSION WIRE	---	115KV CLEARANCE LINE
---		---	GROUND LINE PROFILE

CITY OF FRANKLIN

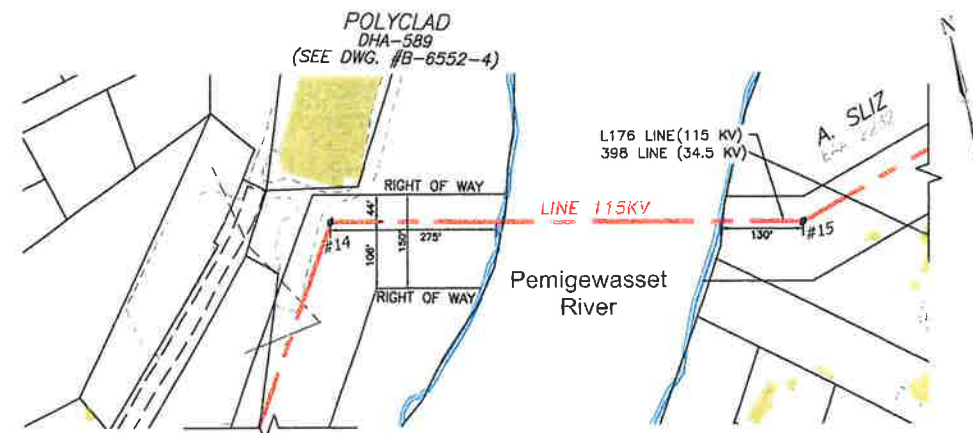
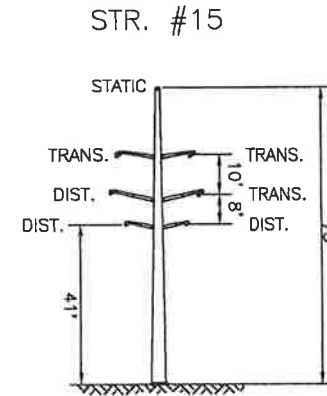
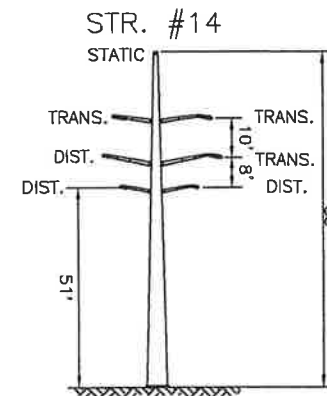

- NOTES:
1. VERTICAL DATUM IS NAVD88 IN FEET.
 2. COORDINATE SYSTEM IS NEW HAMPSHIRE STATE PLANE NAD 83 US SURVEY FEET.
 3. MAP NUMBERS REFER TO TOWN OF BELMONT TAX IDENTIFICATION MAP NUMBERS WITH CORRESPONDING PARCEL IDENTIFICATION NUMBERS.



DWG	REV	ISSUED FOR PERMIT	DATE	CONTR/PE	DATE	DRN	CHKD	APPR
			9/10/19					

EVERSOURCE
ENERGY

LINE L176 115KV TRANSMISSION
NHPUC PEMIGEWASSET RIVER
WATER CROSSING PETITION
EXHIBIT 4

SCALE: NTS
FILE: L176-PERMIT CROSSING DWGS.DWG
IMAGE:

T	D
DRN	DRL/TRC
ENGR	GEL/TRC
CHECKED	SAL/TRC
APPROVED	GEL/TRC
DATE	9/4/19

DRAWING NO.
L17643903